

**WARNING:
IF YOU THINK THE
POWER IS OFF
WHEN THE SWITCH
IS OFF,
YOU'RE WRONG.**

KEEP AWAY FROM WATER

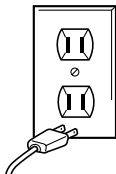

Everybody knows that electricity and water are a dangerous combination. But did you know that an electrical appliance is still electrically alive even if the switch is off? If the plug is in, the power is on. So when you are not using your appliances, keep them unplugged.

ALWAYS UNPLUG SMALL APPLIANCES

Public Service AD from Association of Home Appliance Manufacturers and Underwriters Laboratories, Inc.

STORAGE

Disconnect from electrical outlet. Place Facial Steamer in cool, dry area out of reach of children, where it will not be damaged. Handle cord carefully for longer life; do not jerk or strain at plug connections, or wrap cord around unit for storage. This could cause damage to the cord or a short circuit. To store unit, coil cord loosely.

LIMITED ONE YEAR WARRANTY

Conair will repair or replace (at our option) your unit free of charge for 12 months from the date of purchase if the appliance is defective in workmanship or materials.

To obtain service under this warranty, return the defective product to the service centre listed below that is nearest you, together with your purchase receipt and \$7.50 for postage and handling. In the absence of a purchase receipt, the warranty period shall be 12 months from the date of manufacture.

ANY IMPLIED WARRANTIES, OBLIGATIONS, OR LIABILITIES, INCLUDING BUT NOT LIMITED TO THE IMPLIED WARRANTY OF MERCHANTABILITY AND FITNESS FOR A PARTICULAR PURPOSE, SHALL BE LIMITED IN DURATION TO THE 12 MONTH DURATION OF THIS WRITTEN, LIMITED WARRANTY.

IN NO EVENT SHALL CONAIR BE LIABLE FOR ANY SPECIAL, INCIDENTAL, OR CONSEQUENTIAL DAMAGES FOR BREACH OF THIS OR ANY OTHER WARRANTY, EXPRESS OR IMPLIED, WHATSOEVER.

This warranty gives you specific legal rights, and you may also have other rights, which vary from province to province.

SERVICE CENTRE:

CONAIR CONSUMER PRODUCTS INC.
156 Parkshore Drive,
Brampton, Ontario
L6T 5M1
1-800-472-7606

©2004 Conair Consumer Products Inc.

04CN1099

CONAIR®



THE COMPLETE
facialcare
SYSTEM
WITH 3 UNITS & ATTACHMENTS

Instruction & Styling Guide

For your safety & continued enjoyment of this product, always read the instruction book carefully before using.

3710C Models

IB-5197

IMPORTANT SAFETY INSTRUCTIONS

THIS APPLIANCE IS INTENDED FOR HOUSEHOLD USE. WHEN USING ELECTRICAL APPLIANCES, ESPECIALLY WHEN CHILDREN ARE PRESENT, BASIC SAFETY PRECAUTIONS SHOULD ALWAYS BE TAKEN, INCLUDING THE FOLLOWING:

READ ALL INSTRUCTIONS BEFORE USING KEEP AWAY FROM WATER DANGER

To reduce the risk of electrocution:

1. Always unplug this appliance immediately after using.
2. Do not use while bathing.
3. Do not place or store appliance where it can fall or be pulled into a tub or sink.
4. Do not place in or drop into water or other liquid.
5. Do not reach for an appliance that has fallen into water. Unplug immediately.

WARNING—To reduce the risk of burns, electrocution, fire, or injury to persons:

1. Read all instructions before using the appliance.
2. To protect against electrical hazards, do not use while bathing or in the shower.
3. This appliance should not be used by or near children or by individuals with certain disabilities.
4. Unplug the appliance from outlet when not in use and before cleaning. Do not leave appliance unattended when it is plugged in. Keep cord away from heated surfaces. Do not wrap the cord around the unit.
5. Do not operate this appliance with a damaged cord or plug or if the appliance malfunctions or has been dropped or damaged in any manner. Return appliance to nearest service facility for examination, electrical or mechanical adjustment, or repair. No

repairs should be attempted by the consumer.

6. Use appliance only for intended use as described in this instruction book. The use of attachments not recommended or sold by Conair may cause hazards.
7. Do not use outdoors or operate where aerosol (spray) products are being used, or where oxygen is being administered.
8. Do not use on a soft surface such as a bed, where openings may be blocked.
9. Do not place or store appliance where it can fall or be pulled into a tub or sink.
10. Do not place in or drop into water or other liquid.
11. If an appliance falls into water, unplug it immediately. Do not reach into the water.
12. Never use while sleeping.
13. Do not use additives in the Facial Steamer or Facial Mister. For facial mister, use only with distilled water.
14. Keep edge of Facial mask at least 2" away from skin. Holding Facial Mask against skin may cause scalding.
15. Use on any 120 volt 60 hertz AC electric outlet (ordinary household current). Do not use it on any other electrical outlet.
16. Do not mix old and new batteries. Do not mix alkaline standard (carbon-zinc) or rechargeable (nickel aluminum) batteries
17. Do not touch the steam outlet. It is hot.
18. Steam may condense into hot water in base of facial mask. Drain this water away from the body.
19. Do not use on other persons.
20. Do not store product with water.
21. Do not attempt to move or carry the unit until the water is cool.
22. Unplug this appliance before filling. Fill with water only.
23. Do not use an extension cord with this appliance.
24. Do not the aim Facial Mister into the eyes.

SAVE THESE INSTRUCTIONS OPERATING INSTRUCTIONS

This appliance has a polarized plug (one blade is wider than the other). As a safety feature this plug will fit in a polarized outlet only one way. If the plug does not fit fully in the outlet, reverse plug. If it still does not fit, contact a qualified electrician. Do not attempt to defeat this safety feature.

If you have any skin condition, sensitivity to heat or other health issues or questions, including those relating to use of this product while undergoing any treatments or taking any medications, please consult with a physician before use.

- 1) Your Microdermabrasion Unit and Facial Mister units operate on 2 "AA" batteries each (not included).
- 2) To install batteries, remove the battery cover.
- 3) Install 2 "AA" new batteries as indicated on battery box. (Fig. 1)



Fig. 1

- 4) Replace battery cover by snapping it into place.
- 5) Your Complete Facial Care System contains three units and six attachments. (Fig. 2) The Facial Steamer unit operates on an electric outlet. (Fig. 3) The Microdermabrasion and the Facial Mister units operate on 2 "AA" batteries each.



Fig. 2



Fig. 3

6) The Facial Steamer provides a warm mist or a warm ionized steam to open pores and cleanse thoroughly. Pull out the rubber stopper from the transparent tank and fill the water bottle with water. (Fig. 4) Do not overfill the Facial Steamer past "max" line of water tank. For best results, refill sauna with warm tap water when the water tank level falls to the minimum fill line. If the sauna runs out of water while in use, it may take 5-10 minutes for steaming to restart after refilling.

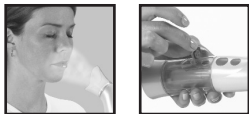

Fig. 4

7) Securely replace stopper before continuing. Snap the Facial Mask attachment to the Facial Steamer. (Fig. 5 & 6)



Fig. 5



Fig. 6

8) Push the lower "On" button : the LED indicator will light and steam will start to come from the unit within a few minutes. By pushing the upper "Ion On" button, the LED light will remain on and the steam will become denser, indicating the ionized steam is operating. (Fig. 7) Do not hold the Facial Steamer in one area for more than 15 seconds. **Do not hold facial steamer mask over nostril openings or inhale steam. Also, avoid delicate skin areas around the eyes and mouth. (Fig. 8)**

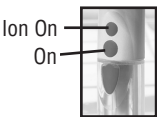

Fig. 7



Fig. 8

9) Your Complete Facial Care System provides a Microdermabrasion Unit with Hi and Lo Speed Indicator. Once unit has been turned on, use the

upper switch to change direction of rotation. The unit rotates in either a clockwise or counterclockwise motion for optimal cleansing. The Microdermabrasion Unit has several accompanying attachments. (Fig. 9) Secure attachments before operating unit by sliding firmly in place. The large brush is ideal for exfoliating large skin surface areas like the forehead, cheeks, and chin. (Fig. 10) The small brush provides targeted exfoliation around the crevices of your nose and upper lip. Use the mesh sponge attachment for gentle daily cleansing. The rotating massager attachment will also fit the Microdermabrasion Unit. Adjust speed indicator settings for desired massage. Either the cotton cloth or the closed cell sponge can be attached when applying moisturizer lotion.



Fig. 9



Fig. 10

10) The cotton cloth should be replaced after each use. To remove the cloth, pull out bottom stem of attachment. Remove old cloth and replace with your favorite cotton cloth. Rest the cloth on top of the stem and firmly secure the ring around the cloth. Now, you are ready to use the cotton cloth attachment again. (Fig. 11-13)



Fig. 11



Fig. 12



Fig. 13

11) To close pores and refresh skin, fill the Facial Mister tank with cool distilled water. (Fig. 14) Hold unit 2" from your face. (Fig. 15) Then push the On/Off button to release a cooling mist.



Fig. 14



Fig. 15

The 6 Step Complete Facial Care System



1. Cleanse face using the mesh sponge and your favorite facial wash.



2. Open pores and purify skin with the heated facial steamer mask ~ optional ionized steam for thorough cleansing.



3. Exfoliate dry skin cells using the Microdermabrasion brush attachments.



4. Refresh with cooling facial mister.



5. Leave skin totally refreshed with the rotating massager attachment.



6. Apply your favorite moisturizer with the cotton cloth or close cell sponge attachments to finish.



MAINTENANCE

Your Complete Facial Care System is designed for household use and is virtually maintenance-free. No lubrication is needed.

If cleaning the Facial Steamer becomes necessary, disconnect the appliance from the power source and wipe exterior with a cloth. The Facial Mister or Microdermabrasion Unit can be cleaned by wiping exterior with a cloth. Do not immerse in water.

Attachments should be cleaned after each use by running them under warm water. Rinse thoroughly and remove any excess water. Allow attachments to air-dry thoroughly before reusing.

If any abnormal condition occurs, unplug the Facial Steamer, allow it to cool, and return it to an authorized service centre for repair.

GETTING TO KNOW YOUR COMPLETE FACIAL CARE SYSTEM

- 1 Heated Facial Steamer with Ionizer
- 2 LED Indicator for "on" & "ion on"
- 3 Water Tank
- 4 Facial Mask
- 5 Water Bottle
- 6 Hi/Lo Speed
- 7 Clockwise/Counterclockwise Rotation
- 8 Large Exfoliating Brush
- 9 Small Exfoliating brush
- 10 Cotton Cloth
- 11 Closed Cell Sponge
- 12 Mesh Buffer
- 13 Rotating Massager
- 14 Sprayer
- 15 On/Off Switch
- 16 Removable Tray
- 17 Base
- 18 Transparent Cover

*requires 2 AA batteries

TO ORDER REPLACEMENT KIT

Model	Description	Price
RPFCA	1 bag contains small brush, large brush, close cell sponge, mesh sponge	\$10.00

Includes shipping and handling

MAIL ORDER TO:

CONAIR CONSUMER PRODUCTS INC.

156 Parkshore Drive,
Brampton, Ontario
L6T 5M1

Include return name and address and model number of replacement pack. Please make cheque payable to Conair Consumer Products Inc.

