

PROFESSIONAL CORD/CORDLESS RECHARGEABLE

# EVEN CUT

easy, effortless self clipping to maintain a short, even cut!



## Have a Question?

Please do not return this product to the retailer.

### Call Us First!

Our customer service and product experts are ready to answer ALL your questions.

Please call our TOLL-FREE customer service number at: 1-855-926-6247 or visit us online at [www.conaircanada.ca](http://www.conaircanada.ca)

### Instruction Booklet

For your safety and continued enjoyment of this product, always read the instruction booklet carefully before using.

Model HG300RC



## IMPORTANT SAFETY INSTRUCTIONS

When using electrical appliances, especially when children are present, basic safety precautions should always be followed, including the following:

### READ ALL INSTRUCTIONS BEFORE USING KEEP AWAY FROM WATER

**DANGER** — any appliance is electrically live, even when the switch is off. To reduce the risk of death or injury by electric shock:

1. Unplug this appliance before cleaning.
2. Do not place or store appliance where it can fall or be pulled into a tub or sink.
3. Do not use while bathing or in a shower.
4. Do not place in, or drop into, water or other liquid.
5. Do not reach for an appliance that has fallen into water. Unplug immediately.
6. Always unplug this appliance from electrical outlet immediately after using.

### DO NOT REACH INTO THE WATER

**WARNING** — To reduce risk of burns, electrocution, fire, or injury to persons:

1. This appliance should never be left unattended when plugged in. Do not pull, twist, or wrap line cord around appliance.
2. This appliance should not be used by, on,

or near children or individuals with certain disabilities.

3. Use this appliance only for its intended purpose as described in this manual. Do not use attachments not recommended by the manufacturer. Do not use an extension cord to operate this appliance.
4. Never operate appliance if it has a damaged cord or plug, or if it is not working properly, if it has been dropped or damaged, or dropped into water. Return appliance to a service center for examination and repair.
5. Keep cord away from heated surfaces.
6. Never drop or insert any object into any opening on this appliance.
7. Do not place appliance on any surface while it is operating.
8. Do not use this appliance with a damaged or broken comb or with teeth missing from the blades, as injury may occur.
9. Do not operate outdoors or where aerosol (spray) products are being used or oxygen is being administered.
10. Never operate the appliance with the air openings blocked or while on a soft surface, such as a bed or couch, where the air openings may be blocked. Keep the air openings free of lint, hair, and the like.
11. Always attach plug to appliance first, then to outlet. To disconnect, turn all controls to "OFF"; remove plug from outlet.
12. Avoid skin contact with moving blades.
13. Check for tangles or kinks in the cord. If the cord does become tangled during use, turn unit off and straighten cord before operating.
14. This product is for household use only.
15. Be sure voltage is in correct voltage before plugging in.

16. For connection to a supply not in U.S.A, use an attachment plug adapter of the proper configuration for the power outlet.

17. CAN ICES-3(B)  
Warning: Changes or modifications to this unit not expressly approved by the party responsible for compliance could void the user's authority to operate the equipment.

## SAVE THESE INSTRUCTIONS OPERATING INSTRUCTIONS

This appliance is intended for household use. Use on Alternating Current only.

Congratulations on your Conair Even Cut™ purchase. This innovative product will help you maintain your clean look in the easiest and most convenient ways possible. For best results, use your Even Cut™ every day — anywhere, anytime! The unique angled shaving foils are designed to follow the unique contours of your head for the most effective, even cutting. If you should skip a couple of days, use the trimmer attachment first to cut the hairs short enough to be able to be cut by the shaving foils. Or use the trimmer attachment with taper control and the different comb sizes to cut and maintain a close or ultra-close look. The comfortable universal grip encourages you to use whichever hand feels most comfortable when cutting the different areas of your head.

### BEFORE YOU START

1. The first time you use your Even Cut™, place the unit in the charging stand so the domed head is securely attached to the charging pin on the stand.
2. Before using the unit for the first time, charge continuously for 16 hours. Maximum battery capacity will only be reached after 3 charging and discharging cycles. Always place the unit in the charging base with the On/Off switch in the Off position.
3. Plug the adapter into any wall outlet (at the voltage listed on the label affixed to the adapter). This power unit is intended to be correctly orientated in a vertical or floor mount position. Unplug adapter when not in use.
4. The adaptor may become warm while charging. This is normal.
5. Preserving the batteries: in order to maintain the optimum capacity of the rechargeable batteries, the unit should be recharged for 16 hours approximately every 3 months.

### CLEAN OR BALD LOOK

To achieve the cleanest, cue ball look with the Even Cut™ shaving foils:

1. Use dry every day for maximum effectiveness and easiest maintenance.
2. For growth of 3 days or more (hair length longer than stubble), use trimmer attachment to cut hair short enough to feed into shaving foils.
3. Use large, relaxed circular motions. This allows the hair to feed into the shaving foils.



4. Do not use excessive pressure — let the cutting system do the work. If skin turns red or gets irritated, this means you are pressing too hard.
5. When shaving the back of the head and neck area, tilt head as far forward as possible to stretch the skin. This will result in a better cut and reduce chances of occasional "nicking" of the skin.
6. Place free hand onto head to feel for stubble that needs to be shaved an additional time.
7. The first few shaving times, this product will take some extra time to shave the head.

**NOTE: Allow 3 weeks for skin and hair to get used to foil shaving.**

### CLOSE OR ULTRA-CLOSE LOOK

Using the trimmer attachment, always cut from the back of the neck forward to the crown, using the 3/8 in. (0.95 cm) comb first. Position the comb attachment flat against the head and slowly move the Even Cut™ up through the hair. Use the same technique for the sides, cutting from the bottom to the upper side of the head. If you want hair to be shorter, switch to the 1/4 in. (0.64 cm) or 1/8 in. (0.32 cm) comb attachment.



### FADE CUT

For the best fade cut, start with the

1/8 in. (0.32 cm) attachment on your Even Cut™ clipper. Starting at the middle of the nape of the head, slide the trimmer up from the bottom of the hairline while gently pulling away from the head as you go and finish with a scooping motion. Repeat this around the back and sides of the head.



Next, attach the 3/8 in. (0.95 cm) attachment and run the Even Cut™ over the top of the head, holding it evenly to the scalp. Pull the Even Cut™ toward you from the front top of the head to the back. Note: Hair should be cut against the way it grows so as to get an even cut.



Now use the 1/4 in. (0.64 cm) attachment and hold a comb perpendicular to the head and use the clipper-over-comb technique to blend the lower and mid area of the head to eliminate any line.



Remove the attachment and trim the front hairline by holding the Even Cut™ sideways with blade facing down and touching the edge to the hairline. Next, trim the back of the hairline by holding the Even Cut™ blade face down to the bottom edge of the hairline and pulling down. For



a more natural fade, you can also use the Even Cut™ over comb technique to clean up the hairline.

To trim around the ear, hold the clipper on its side, facing down, and use the corner of the trimmer in an arching motion to get a clean edge to the hairline around the ear.



### ADJUSTABLE 3-POSITION TAPER CONTROL

The taper control switch at the back of the trimmer attachment lets you gradually adjust the closeness of the cut. For the closest cut and the shortest hair, push taper switch all the way to the right. To increase cutting length, slowly push switch to the left. The three hair length settings, from left to right, are 2.8 mm, 1.8 mm and 0.8 mm.

Packed-in hair can slow down any set of cutting blades. To clean the blades, remove trimmer attachment and brush the hair from the blades using the cleaning brush provided. If you do this after every use, especially with heavy hair cutting, the blades should remain free of cut hair.

If the blades stop cutting but do not stop running, then it is time to replace the trimmer attachment.

### STOP. COMB. CHECK.

For best results, do as the professionals do: comb hair often, and check cutting results as you comb to avoid unevenness.

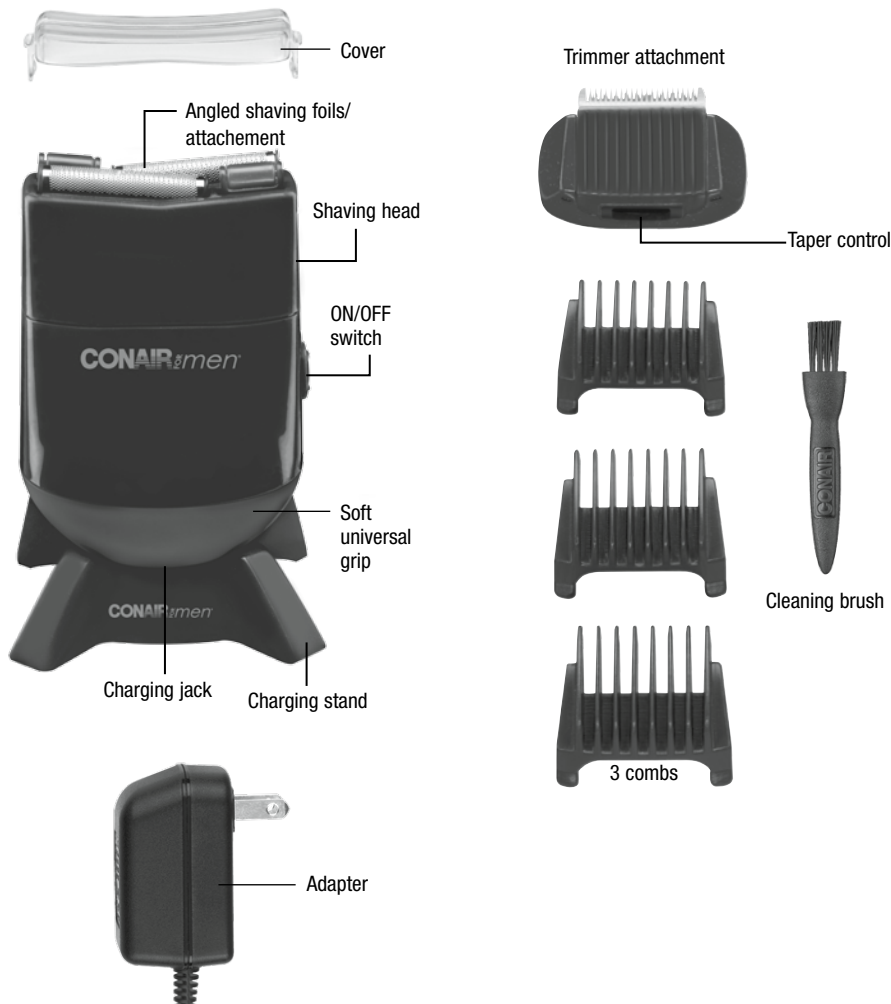

## USER MAINTENANCE INSTRUCTIONS

### DETACHABLE SHAVING HEAD

You will need to remove the shaving head in order to clean the cutting assembly, and before installing the trimmer attachment. The shaving head contains the cutting assembly of the Even Cut™ unit, comprised of the shaving foils and inner cutters.

**To remove the shaving head:** Pull head up to separate from housing.

**To attach the shaving head:** Align the marks on the head and on the housing, and push head down until it snaps into place. Note: The shaving head will fit only one way.

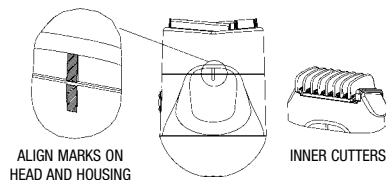

### CLEANING THE CUTTING ASSEMBLY

1. Remove the shaving head as instructed above.
2. Holding the shaving head in one hand, turn it over to expose the internal plastic mechanism. Do not place head upside down on any surface, as this may damage the shaving foils.



3. Grab the two locking tabs and squeeze them toward one another to release the cutting assembly.
4. Lift cutting assembly off the shaving head.



5. Blow between the cutters and tap the shaving head softly to remove hair clippings.

6. Snap the cutting assembly back into the shaving head and replace the shaving head onto the Even Cut™ housing.

### OILING THE INNER CUTTERS

To ensure maximum cutting performance, we recommend that you lubricate the inner cutters occasionally. Release the cutting assembly, as described above. Hold the cutting assembly upside down and apply a few drops of light mineral oil to the front and sides of inner cutters. Wipe excess oil off with a soft, dry cloth.

### CLEANING THE TRIMMER ATTACHMENT

Clean the blades of the trimmer attachment after each use with the cleaning brush provided. Important: Remove trimmer attachment from unit before cleaning. (Remove trimmer attachment in the same way as the shaving head).

### BATTERY REMOVAL

Using a Phillips head screwdriver, remove the screws from the top and inner housing of the shaver. Lift and remove the printed circuit attached to the batteries. Very carefully disconnect the connections before removing the batteries.

**CAUTION:** Beware of any sharp edges.



CONTAINS NICKEL-METAL HYDRIDE BATTERY. MUST BE COLLECTED, RECYCLED OR DISPOSED OF PROPERLY. DO NOT DISPOSE OF IN THE MUNICIPAL WASTE.

TO REMOVE THE BATTERY BLOCK FOR DISPOSAL OR RECOVERY, FOLLOW THESE INSTRUCTIONS:

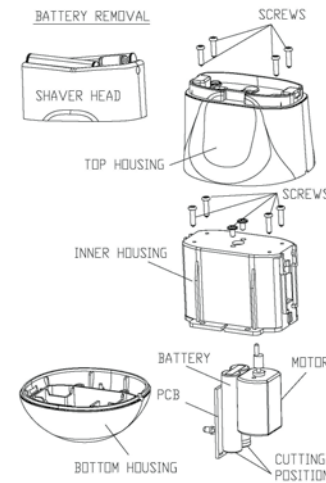

### LIMITED THREE YEAR WARRANTY

Conair will repair or replace (at our option) your unit free of charge for 36 months from the date of purchase if the appliance is defective in workmanship or materials.

To obtain service under this warranty, return the defective product to the service centre listed below, together with your purchase receipt and \$5.50 for postage and handling. In the absence of a purchase receipt, the warranty period shall be 36 months from the date of manufacture.

**ANY IMPLIED WARRANTIES, OBLIGATIONS, OR LIABILITIES, INCLUDING BUT NOT LIMITED TO THE IMPLIED WARRANTY OF MERCHANTABILITY AND FITNESS FOR A PARTICULAR PURPOSE, SHALL BE LIMITED IN DURATION TO THE 36 MONTH DURATION OF THIS WRITTEN, LIMITED WARRANTY.**

**IN NO EVENT SHALL CONAIR BE LIABLE FOR ANY SPECIAL, INCIDENTAL, OR CONSEQUENTIAL DAMAGES FOR BREACH OF THIS OR ANY OTHER WARRANTY, EXPRESS OR IMPLIED, WHATSOEVER.**

This warranty gives you specific legal rights, and you may also have other rights, which vary from province to province.

### SERVICE CENTRE: CONAIR CONSUMER PRODUCTS ULC.

100 Conair Parkway  
Woodbridge Ontario, L4H 0L2  
©2016 CONAIR CONSUMER PRODUCTS ULC.

For more information on any  
Conair product call:  
1-855-926-6247  
Visit our Web site: [www.conaircanada.ca](http://www.conaircanada.ca)  
Consumer Call Centre E-mail:  
[Consumer\\_Canada@Conair.com](mailto:Consumer_Canada@Conair.com)