

## ROTARY NOSE & EAR TRIMMER

1. Make sure the trimmer is in the OFF position.
2. Insert the pin of the trimmer body into the hexagonal hole of the trimmer head as shown (Fig. 1).
3. Press and snap the trimmer head onto the body as shown (Fig. 2).
4. Use trimmer in a circular motion.

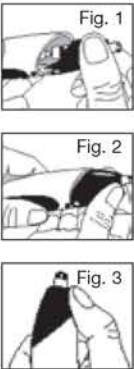

## BATTERY REMOVAL

1. Using a small Phillips head screwdriver, remove the screws at the back of the trimmer.
2. Remove the bottom housing and cut the battery out. Bring the battery to the nearest collection center for proper disposal. DO NOT throw the battery into the normal municipal waste system.



CONTAINS LITHIUM ION BATTERY. MUST BE COLLECTED, RECYCLED OR DISPOSED OF PROPERLY. DO NOT DISPOSE OF IN THE MUNICIPAL WASTE.

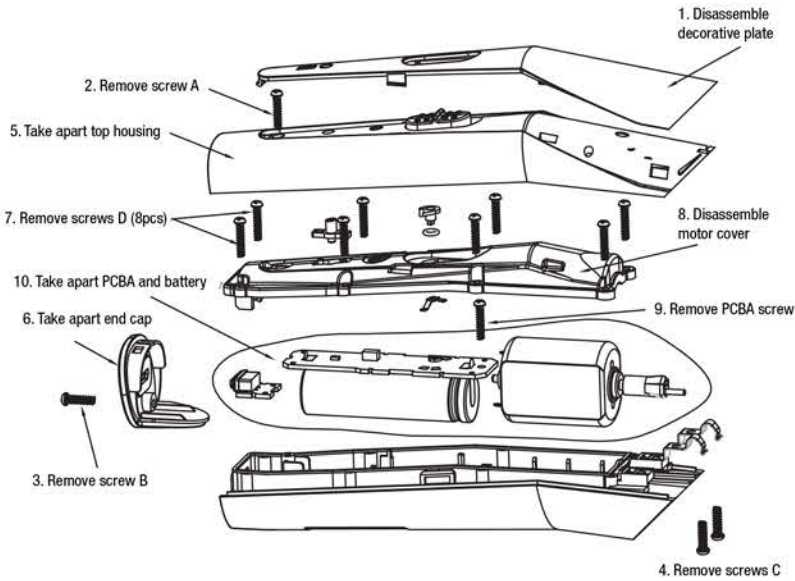

## IMPORTANT SAFETY INSTRUCTIONS

When using electrical appliances, especially when children are present, basic safety precautions should always be taken, including the following:

## READ ALL INSTRUCTIONS BEFORE USING

### FOR HOUSEHOLD USE ONLY KEEP AWAY FROM WATER

**DANGER** — Any appliance is electrically live, even when the switch is off.

To reduce the risk of death or injury by electric shock:

1. **Always unplug appliance from electrical outlet immediately after using (except when charging unit).**
2. Do not place or store appliance where it could fall or be pulled into a tub or sink.
3. Do not use appliance while bathing or in the shower.
4. Do not place appliance in, or drop into water or other liquids.
5. **If appliance has fallen into water, do not reach for it. Unplug immediately.**
6. Unplug this appliance before cleaning.

**WARNING** — To reduce the risk of burns, electric shock, fire, or injury to persons:

1. **Never leave a plugged-in appliance unattended.**

2. This appliance should not be used by, on, or near children or individuals with certain disabilities.
3. Use appliance only for its intended use as described in this manual. Use only attachments recommended by the manufacturer. Do not use an extension cord to operate the appliance.
4. **Never operate the appliance if it has a damaged cord or plug, is not working properly, has been dropped or damaged, or dropped into water. Return the appliance to a Conair Service Center for examination and repair.**
5. Keep the appliance cord away from heated surfaces.
6. Do not pull, twist or wrap the cord around the appliance.
7. Do not bend or abuse the charging wire of the power supply, as this can cause electrical shock and problems.
8. Never drop or insert any object into any opening on the appliance.
9. Do not place the appliance on any surface while it is operating.
10. Do not use the appliance with a damaged or broken comb or with teeth missing from the blades, as injury may result. Before each use, make certain the blades are aligned properly and oiled.
11. Do not use the appliance outdoors or where aerosol (spray) products are being used or where oxygen is being administered.
12. This appliance is not a toy. Keep away from children.
13. **THIS PRODUCT IS FOR HOUSEHOLD USE ONLY.**
14. CAN ICES-3(B)
15. Men whose skin is sensitive or easily irritated by grooming, or who suffer from a skin allergy,

- should test one section on the leg or arm before using the body groomer.
  16. The foils are thin and precisely finished pieces. Do not press hard against the foils or drop foils. A warped or distorted foil will produce poor shaving results. Also a damaged foil may cause skin injury. A damaged foil should be replaced immediately.
  17. Because the body groomer blades are precision-made for a very special use, they should always be handled with care. Each time you finish using the body groomer, take the cleaning brush provided and brush away any loose hair that has collected in the blades. Then store the body groomer in its storage pouch to protect the blades until the next use.
- Be especially careful when changing or adjusting blades. When you have your body groomer serviced, be sure that both blades are sharpened or replaced at the same time.
- To promote the long life of the appliance, use your body groomer only for the purpose intended by the manufacturer.

## SAVE THESE INSTRUCTIONS

### USER MANUAL

Before using the Class 2 Power Supply, read these instructions carefully.

**Use with adapter CA58**

**Adapter model:** C050060-A

**Rated input voltage:** 100–240V AC, 50/60Hz 0.2A

**Rated output:** 5.0V DC 600mA

### CAUTION

1. Dry location use only. Do not expose to liquids, vapor, or rain.
2. Ensure jack is plugged into the trimmer unit

## GMTL25C



- before plugging the adapter into the outlet.
3. Do not operate any appliance that has a damaged output cord or housing.
4. Always unplug the unit before cleaning or when not in use.
5. This power unit is intended to be correctly oriented in a vertical or floor-mount position.
6. Be sure voltage is correct before plugging in. For connection to a power supply not in the U.S.A, use an attachment plug adapter of the proper configuration for power outlet. The adapter included automatically adjusts to the input voltage. **DO NOT USE WITH A VOLTAGE CONVERTER.**

### TRIMMER OPERATING PRECAUTIONS

This trimmer has a built-in rechargeable battery. Do not throw into fire, apply heat, or charge, use or leave in a high-temperature environment.

### TROUBLESHOOTING

If your rechargeable trimmer does not seem to be taking a charge, take the following troubleshooting steps before returning it for repair:

1. Be sure the electrical outlet is working by plugging in another appliance to test the outlet.
2. Make sure the electrical plug is not connected to a switch that turns power off when lights are turned off.

## OPERATING INSTRUCTIONS

### CHARGING

1. Before using the trimmer for the first time, charge continuously for 5 hours. Maximum battery capacity will be reached only after 3 charging and discharging cycles.
  2. To charge the trimmer, first ensure the trimmer is switched off, then insert the small plug on the charging adapter into the hole on the bottom of the trimmer. Plug the adapter into any wall outlet (at the voltage listed on the label affixed to the adapter). Unplug adapter when not in use.
  3. The adapter may become warm while charging, this is normal.
  4. The blue charging LED indicator light around ON/OFF switch on the trimmer will flash when correctly connected. When it is fully charged, the blue charging LED indicator light will stay blue and stop flashing.
  5. A full charge will supply 4 hours of cordless runtime. A quick charge of 20 minutes provides 10 minutes of cordless runtime.
  6. When the trimmer is running low on a charge, the LED indicator light will flash, warning you that there is approximately 3 minutes of battery use remaining.
  7. To maintain optimum capacity of the rechargeable battery, it is highly recommended to fully discharge and then recharge the trimmer for 5 hours every 6 months.
  8. When charging, the unit can't operate.
- WARNING:** If the charging light suddenly starts to flash rapidly, the appliance is faulty. If this happens, please stop charging and remove the adapter from the outlet and contact our customer care center for further advice.

### TRAVEL LOCK

To prevent the appliance from switching on unintentionally, you can lock the ON/OFF button. Press and hold down the ON/OFF switch for 2 seconds. If the ON/OFF button is pressed now, the lock function appears briefly. The appliance, however, does not switch on.

If you want to unlock your appliance, press and hold down the ON/OFF button for 2 seconds. Then the appliance can work normally when switched on.

### TRIMMER CHARGING PRECAUTIONS

- Avoid charging the batteries at temperatures below 41°F (5° C) or above 95°F (35° C).
- Avoid charging the batteries in direct sunlight or near a radiating heat source.
- Even though the trimmer may not be used for an extended period of time, charge once a month to preserve battery life.

### CORDLESS OPERATION

- Insert the adapter into the base of the appliance, plug into a suitable outlet and switch off. The blue LED light will appear when the adapter is correctly inserted into the appliance and connected to the outlet.
- When charging the appliance with the adapter, switch the trimmer on and, if it still does not work, then keep charging.
- Once the appliance is fully charged, the blue LED light will stop flashing, but remain on. Unplug the adapter from the outlet, then the appliance, and prepare for use.

## LIMITED TWO-YEAR WARRANTY (U.S. AND CANADA ONLY)

Conair will repair or replace, at our option, your appliance free of charge for 24 months from the date of purchase if the appliance is defective in workmanship or materials.

To obtain service under this warranty, return the defective product to the service centre listed below, together with your sales slip and \$7.50 for postage and handling. In the absence of a receipt, the warranty period shall be 24 months from the date of manufacture.

**ANY IMPLIED WARRANTIES, OBLIGATIONS, OR LIABILITIES, INCLUDING BUT NOT LIMITED TO THE IMPLIED WARRANTY OF MERCHANTABILITY AND FITNESS FOR A PARTICULAR PURPOSE, SHALL BE LIMITED IN DURATION TO THE 24-MONTH DURATION OF THIS WARRANTY.**

**IN NO EVENT SHALL CONAIR BE LIABLE FOR ANY SPECIAL, INCIDENTAL, OR CONSEQUENTIAL DAMAGES FOR BREACH OF THIS OR ANY OTHER WARRANTY, EXPRESS OR IMPLIED, WHATSOEVER.**

This warranty gives you specific legal rights, and you may also have other rights which vary from province to province.

## USER MAINTENANCE INSTRUCTIONS

### REMOVING THE BLADE SET

1. Make sure the trimmer is in the OFF position.
2. Place your thumb against the smaller cutter and push up to remove the blade set.

### REPLACING THE BLADE SET

1. Make sure the trimmer is in the OFF position.

2. Align the back prong of the trimmer blade with the guide slot on the trimmer housing, place your thumb on top of the blade and snap into place.

### OILING THE BLADES (OIL INCLUDED)

1. Oil the trimmer once a month.
2. Turn the trimmer on.
3. Hold and point the blades downward.
4. Spread one drop of oil across the blades
5. Turn the trimmer off and wipe away any excess oil.

### NOTE:

1. Do not over-oil the blades as this can damage the motor.
2. Do not oil the motor bearing as it is permanently lubricated.
3. **KEEP OIL AWAY FROM CHILDREN.**

### BLADE CARE

1. Brush away any loose hair that collects in the blades.
2. Store the trimmer in a safe location.

## Under THE BELT

### Trimmer & Shaver



## Have a Question?

*Please do not return this product to the retailer.*

### Call Us First!

Our customer service and product experts are ready to answer ALL your questions.

Please call our TOLL-FREE customer service number at: **1-855-926-6247** or visit us online at **www.conaircanada.ca**

### Instruction Booklet

For your safety and continued enjoyment of this product, always read the instruction booklet carefully before using.

# CONAIRMAN

Respect the Ritual™

Model GMTL25C

20CN077233

IB-17163

gently so the hair can get into the holes of the foil; pressing too hard makes the hair flat. Please be patient; use your body groomer 10 to 12 times before you judge its performance.

### BLENDING THE JAWLINE

Attach a jawline comb to the trimmer, hold the trimmer in an upright position and begin trimming under your jawline, using short, even strokes.

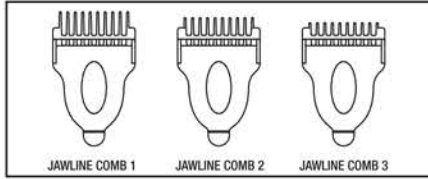

### TRIMMING YOUR MUSTACHE

1. Start with a clean, slightly damp mustache (NOT WET).
2. Comb through your mustache in the direction it grows.
3. Trim your mustache from the top down; finish by outlining the bottom of your mustache.
4. Start with the 5-position attachment comb on the longest setting as you can always go back and shorten the length as desired.

